

Orangeburg County Zoning and Planning Department
1437 Amelia St. Orangeburg, SC 29115
Ph: 803-268-2934 Email: asievers@orangeburgcounty.org

**SITE LAYOUT – SEE NEXT SHEET FOR
EXAMPLE**

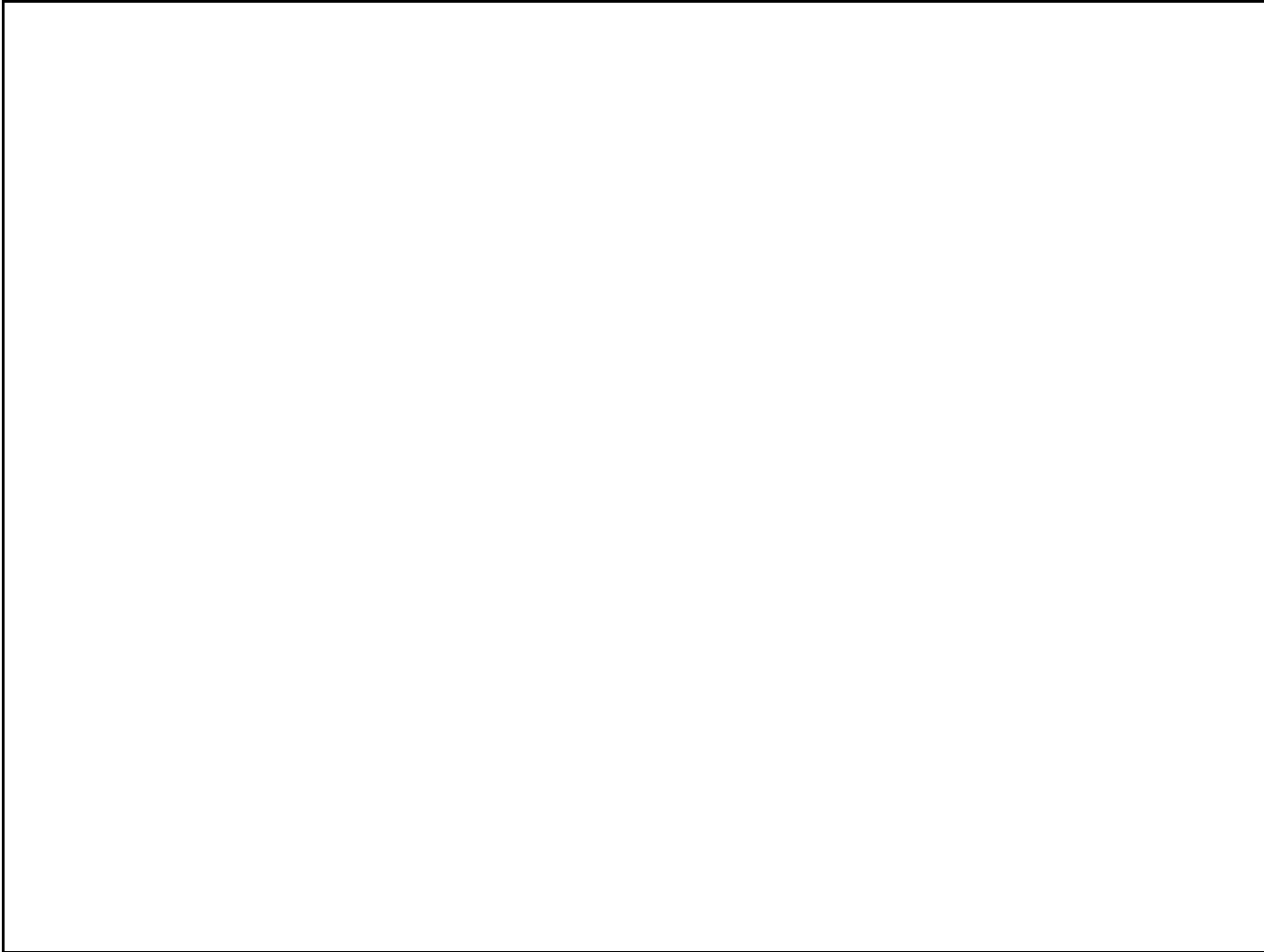

PRINTED NAME

SIGNATURE

DATE

ANY VARIATION FROM THE ABOVE DIMENSIONS WILL REQUIRE A RESUBMITTAL TO THE ZONING DEPARTMENT FOR APPROVAL.

THIS IS A SAMPLE SHEET TO SHOW HOW THE SITE LAYOUT IS TO BE DRAWN.

ON THE PREVIOUS SHEET

SKETCH AN OUTLINE OF THE PROPERTY WITHIN THE BOX PROVIDED.

INSERT THE PROPOSED TYPE OF STRUCTURE.

LABEL STRUCTURE TYPE.

PROVIDE DISTANCE (FEET) FROM STRUCTURE TO PROPERTY LINES.

INDICATE STREET NAMES IF AND WHERE THEY APPLY.

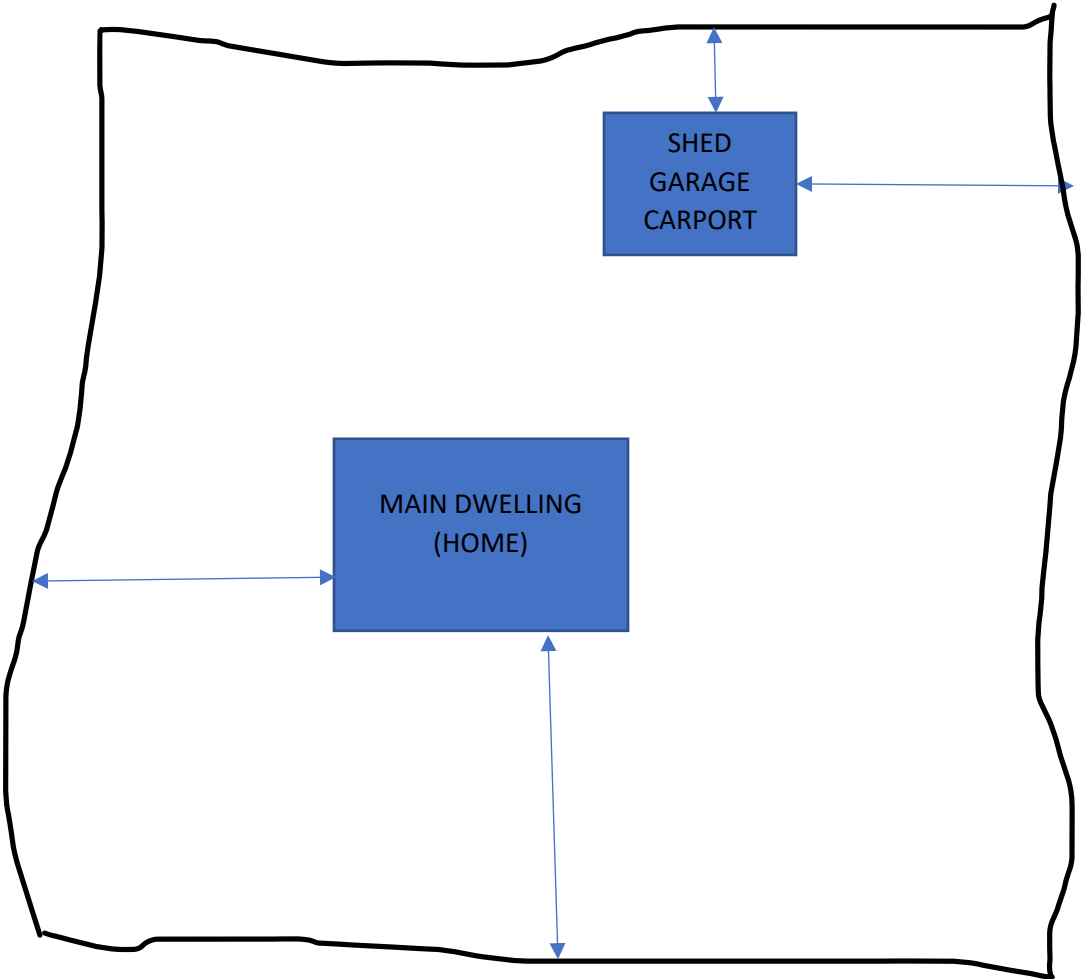

**NAME OF STREET IF THERE IS ONE LOCATED
ADJACENT TO PROPERTY**